

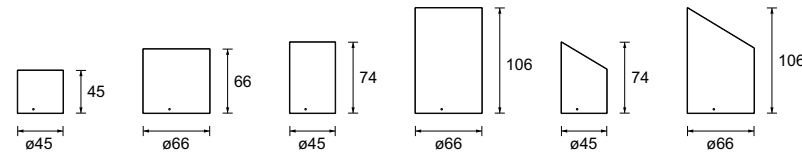

Evo snoots provide glare control and eliminate light spill. There are three bayonet snoot variations: short, long and glare guard, all compatible with our Evo range. Available in MR11 and MR16, these snoots come in brushed aluminum, rubbed bronze, black and white finishes as standard, with custom finishes available on request.



Compatibility	MR11	MR16	MR11	MR16	MR11	MR16
Weight [AL]	20g	60g	30g	95g	25g	75g
Weight [RB]	60g	180g	90g	270g	75g	225g



There are two accessory holder variants available for the Evo snoot range. The double accessory holder fits into all three bayonet snoots and holds up to two lenses or louvres. There is also a double accessory holder with a wall wash reflector for the glare guard snoot. We recommend using a prismatic lens and a narrow beam lamp in conjunction with the wall wash reflector.

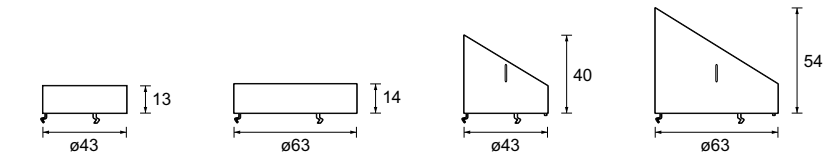

Compatibility	MR11	MR16	MR11	MR16
Weight [BK]	10g	15g	15g	35g



	243-AL-01	253-AL-01	242-AL-01	252-AL-01	241-AL-01	251-AL-01
	243-RB-01	253-RB-01	242-RB-01	252-RB-01	241-RB-01	251-RB-01
	243-BK-01	253-BK-01	242-BK-01	252-BK-01	241-BK-01	251-BK-01
	243-WH-01	253-WH-01	242-WH-01	252-WH-01	241-WH-01	251-WH-01

	244-BK	254-BK	245-BK	255-BK

# evo projector



The Evo Projector is an accessory designed to fit the base of an Evo 16, converting the luminaire into a framing projector. The aperture is adjusted using removable framing arms, and the beam can be controlled using a focusing wheel. The design also includes a gobo rotator. The projector can accept an optional double accessory holder, and is available in brushed aluminium, black and white, with other finishes available on request.



**Category** Interior use only IP20

**Materials** Machined Aluminium

**Finish** Brushed Aluminium | Black | White | Custom

**Fitting** Evo 16

**Lamp** MR16

**Rating** 50W Max at 12V

**Weight** AL | BK | WH - 400g

**Accessories** Louvres | Lenses [p. 80]

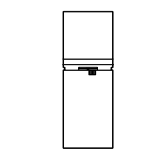
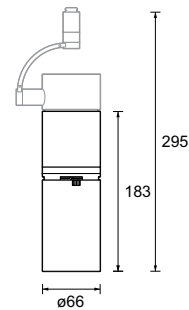

EVO PROJECTOR

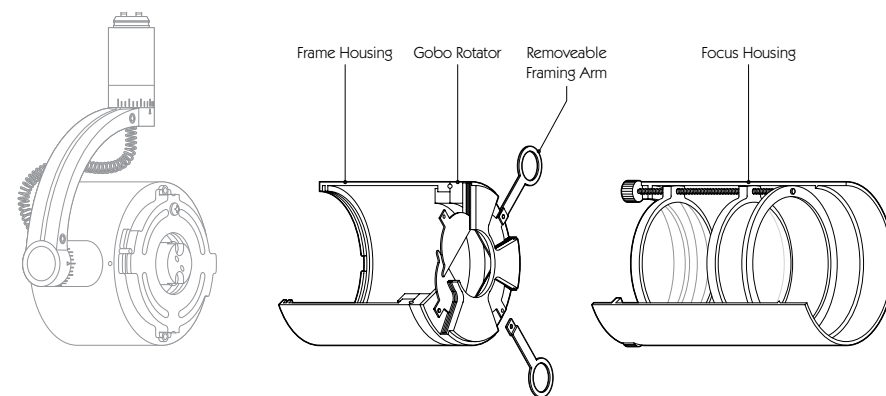

	256-AL-01
	256-BK-01
	256-WH-01





Screw-on snoots provide glare control and reduce light spill. There are three variations: short, long and wall wash, which are compatible with our Retro and Microspot luminaires. Available in MR11 and MR16, these snoots can also hold a lens or louvre. Brushed aluminium, rubbed bronze, black and white finishes are available as standard, with custom finishes on request.

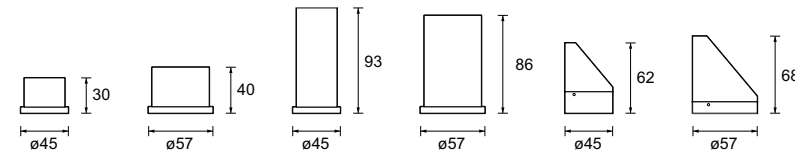

Compatibility	MR11	MR16	MR11	MR16	MR11	MR16
Weight [AL]	15g	35g	55g	70g	35g	50g
Weight [RB]	50g	105g	170g	215g	100g	150g

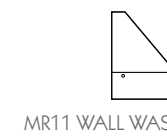
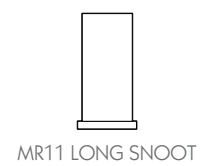

MR11 SHORT SNOOT    MR16 SHORT SNOOT    MR11 LONG SNOOT    MR16 LONG SNOOT    MR11 WALL WASH SNOOT    MR16 WALL WASH SNOOT

Finish	MR11 Short Snoot	MR16 Short Snoot	MR11 Long Snoot	MR16 Long Snoot	MR11 Wall Wash Snoot	MR16 Wall Wash Snoot
Brushed Aluminium	987S-11-AL	987S-16-AL	987L-11-AL	987L-16-AL	987W-11-AL	987W-16-AL
Rubbed Bronze	987S-11-RB	987S-16-RB	987L-11-RB	987L-16-RB	987W-11-RB	987W-16-RB
Black	987S-11-BK	987S-16-BK	987L-11-BK	987L-16-BK	987W-11-BK	987W-16-BK
White	987S-11-WH	987S-16-WH	987L-11-WH	987L-16-WH	987W-11-WH	987W-16-WH



Accessory Holders are used to attach snoots, lenses and louvres directly to the front of the lamp. The QR111 version is compatible with the Radar and Maxilumen fittings, and the MR16 version with the Demilumen, Rotor, Phantasia and Phantamount fittings. Accessory Rings replace the standard front ring on the Retro and Microspot luminaires and allow two lenses or louvres to be fitted.

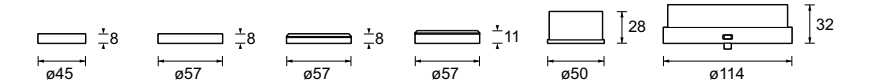

Compatibility	MR11	MR16	MR16	MR16	MR16	QR111
Weight [AL]	5g	10g	10g	15g	15g	35g
Weight [RB]	15g	25g	30g	45g		



Finish	MR11 Accessory Ring	MR16 Accessory Ring	SGL. Accessory Holder	DBL. Accessory Holder	QR111 Snoot	SNOOT
Brushed Aluminium	11D-AL-02	16D-AL-02	940-AL	945-AL	987-AL	987-AL-111
Rubbed Bronze	11D-RB-02	16D-RB-02	940-RB	945-RB		
Black	11D-BK-02	16D-BK-02	940-BK	945-BK	987-BK	987-BK-111
White	11D-WH-02	16D-WH-02	940-WH	945-WH	987-WH	987-WH-111



Each spotlight in our range can be fitted with a variety of different lens and louvre options enabling it to be tailored to your personal needs. Coloured, dichroic and Museum grade UV filters are also available on request.

	37mm	50mm	55mm	101mm
<b>Compatibility</b>	EVO 11   MR11	MR16	EVO 16	QR111
<b>LENS CLIP [AL]</b>				
<b>LENS CLIP [BK]</b>				
<b>SANDBLASTED LENS</b>				
<b>SOFTENING LENS</b>				
<b>SPREADER LENS</b>				
<b>HONEYCOMB LOUVRE</b>				
<b>PRISMATIC LENS</b>				
37mm				
50mm	942-AL	942-BK		
55mm				
101mm				

Precision Lighting stocks a wide range of high quality lamps from BLV and Osram, and can also supply any other lamp type as required. As well as the standard Titan MR11 and Reflekt MR16 ranges from BLV, we also stock the black and silver backed Reflekt lamps, and the Eurostar Powersaver range of infrared coated lamps that give greater outputs at lower wattages. Technical lamp information is available via our website.



	LAMP WATTAGE (W)	BEAM ANGLE (°)	LUMINOUS INTENSITY (cd)	COLOUR TEMPERATURE (K)	ORDER CODE
BLV REFLEKO CLEAR MR16 GU5.3	20	12	3500	2900	MR16-ESX-CL
	20	36	600	2900	MR16-BAB-CL
	35	12	6000	2900	MR16-FMT-CL
	35	24	2300	2900	MR16-FMV-CL
	35	36	1300	2900	MR16-FMW-CL
	50	12	11000	2950	MR16-EXT-CL
	50	24	3600	2950	MR16-EXZ-CL
	50	36	2000	2950	MR16-EXN-CL
BLV BLACK BACK MR16 GU5.3	20	36	510	2900	MR16-BAB-BB
	35	36	1200	2950	MR16-FMW-BB
	50	24	3000	3000	MR16-EXZ-BB
	50	36	1580	3000	MR16-EXN-BB
BLV SILVER BACK MR16 GU5.3	20	36	510	2900	MR16-BAB-SB
	35	36	1200	2950	MR16-FMW-SB
	50	24	3000	3000	MR16-EXZ-SB
	50	36	1580	3000	MR16-EXN-SB

	LAMP WATTAGE (W)	BEAM ANGLE (°)	LUMINOUS INTENSITY (cd)	COLOUR TEMPERATURE (K)	ORDER CODE
BLV POWERSAVER MR16 GU5.3	35	12	11000	3000	MR16-FMT-PS
	35	24	3600	3000	MR16-FMV-PS
	35	36	2000	3000	MR16-FMW-PS
	50	12	13000	3000	MR16-EXT-PS
	50	24	4800	3000	MR16-EXZ-PS
BLV TITAN CLEAR MR11 GU4	20	10	3200	2900	MR11-FTB
	20	38	500	2900	MR11-FTD
	35	10	5400	2900	MR11-FTE
OSRAM QR111 G53	50	04	40000	3000	AR111-50-4°
	50	08	20000	3000	AR111-50-8°
	50	24	4000	3000	AR111-50-24°
BLV Capable G4	75	08	30000	3000	AR111-75-8°
	75	24	5300	3000	AR111-75-24°
	75	45	2000	3000	AR111-75-45°

# transformers

We stock a wide range of electronic and magnetic transformers for use with all our systems and monopoints. All our transformers have short circuit and thermal protection with either automatic or manual reset functions.

We recommend using a toroidal transformer for all our track and cable systems. They are intended for installation in a remote location where possible. Runs of power feed cable should be kept as short as possible to minimise unnecessary voltage drop. Electronic transformers are suitable for use with the Monopoint luminaires, and also for runs of track where the distance between transformer and the furthest luminaire does not exceed three metres. Please contact us for guidance on which transformer to specify with different systems.



**Category** Interior use only IP20  
**Type** Toroidal  
**Approval Markings** CE  
**Finish** White  
**Compatibility** Basis Track I  
 Cable System I ReTrac



**Category** Interior use only IP20  
**Type** Electronic  
**Approval Markings** CE  
**Finish** White  
**Compatibility** Monopoints I  
 Track systems [up to 3m]



**Category** Interior use only IP20  
**Type** Electronic  
**Approval Markings** CE  
**Finish** Black  
**Compatibility** Monopoints I  
 Track systems [up to 3m]

	POWER OUTPUT (VA)	TRANSFORMER TYPE	VOLTAGE INPUT (V)	VOLTAGE OUTPUT (V)	FREQUENCY (Hz)	AMBIENT TEMP. (°C max)	CASE TEMP. (°C max)	DIMENSIONS (L x W x H)	WEIGHT (KG)	COLOUR	ORDER CODE
<b>TOROIDAL</b> 	200	TOROIDAL	240	12	50	30	NA	260 x 135 x 75	3.00	WH	PS200T
	300	TOROIDAL	240	12	50	30	NA	260 x 135 x 75	3.65	WH	PS300T
	400	TOROIDAL	240	12	50	30	NA	290 x 160 x 90	5.60	WH	PS400T
	500	TOROIDAL	240	12	50	30	NA	290 x 160 x 90	5.70	WH	PS500T
<b>MODE</b> 	75	ELECTRONIC	240	11.8	50-60	55	90	150 x 50 x 35	0.15	WH	PS75E-M
	105	ELECTRONIC	240	11.8	50-60	55	90	150 x 50 x 35	0.15	WH	PS105E-M
	150	ELECTRONIC	240	11.8	50-60	50	90	225 x 55 x 45	0.40	WH	PS150E-M
	210	ELECTRONIC	240	11.8	50-60	45	90	225 x 55 x 45	0.40	WH	PS210E-M
	255	ELECTRONIC	240	11.8	50-60	45	90	295 x 65 x 45	0.55	WH	PS255E-M
	315	ELECTRONIC	240	11.8	50-60	40	90	295 x 65 x 45	0.55	WH	PS315E-M
<b>TCI</b> 	60	ELECTRONIC	240	11.5	50-60	45	85	87 x 30 x 20	0.05	BK	PS60E
	105	ELECTRONIC	240	11.5	50-60	55	95	110 x 35 x 25	0.08	BK	PS105E



All weights and measurements are believed to be correct at time of going to press. Precision Lighting reserves the right to modify or withdraw any of their products without notice. Every effort has been made to ensure product colours have been reproduced accurately. However, due to the printing process, actual colours may differ. Rubbed Bronze fittings are hand finished which can lead to minor variations in colour. For your convenience we have included colour samples that can be found on the page opposite.

For the latest news and updates of all our products, check our website [www.precisionlighting.co.uk](http://www.precisionlighting.co.uk).



catalogue design & artwork by simon harrison-wallace  
w. [www.shwdesign.com](http://www.shwdesign.com) • e. [simon@shwdesign.com](mailto:simon@shwdesign.com)