

## NARROW SPOT

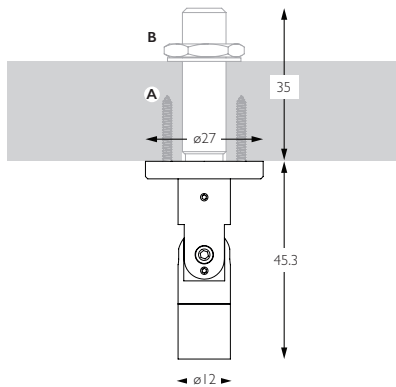

A - 2 Screw Fixing

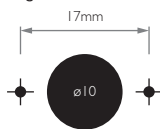

B - M10 Fixing



If M10 stud is restricting installation contact us for removal

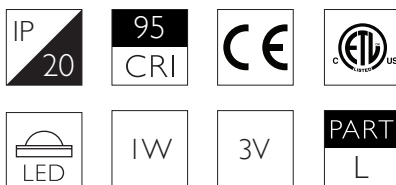

### Technical Description

Atto surface is a miniature, display orientated LED spotlight that comes as standard in white, black and brushed aluminium finishes. It has four site changeable optics for flexible distribution. The narrow spot beam in our 1W 102lm module has a peak intensity of 794cd. The Atto has 360 degree bearing aided rotation and 180 degree constant torque tilt mechanism, both lockable. There are 2 mounting methods, from the front using screws or from the rear using the M10 threaded stud - this can be factory removed as a custom order if it restricts installation.

### Mechanical & Electrical

**Category** Interior use only IP20  
**Material** Aluminium I Brass  
**Lockable** Pan & Tilt  
**Accessories** Snoots

**Systems** Fixed monopoint  
**Weight** 16g  
**Forward Voltage** 3V  
**Current** 350mA

### Finishes

**Finishes** Brushed Aluminium I Black I White I Brass I Custom\*

\* Please enquire as to the availability of non-standard Finishes

### Optical

**System Power** 1W  
**Module Output** 102lm  
**Absolute Output** 94lm  
**Gear Type** Dimmable available

**Colour Temperature** 3000K\*  
**CRI** 95 TYP  
**TM-30** RF: 93 RG: 99  
**Beam Angle** 16°

\*\* Photometry shown is correct for 3000K module. Please enquire for 2700K module output.

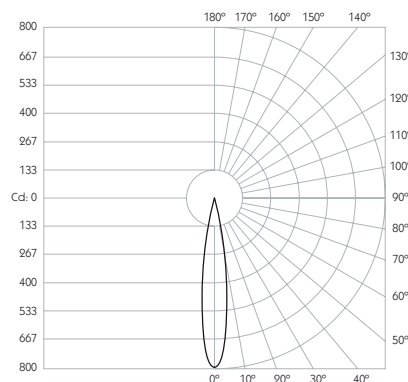

Distance (m)	Beam Diameter (m)	Beam Area (m²)	Footcandle (lx)
0.25	0.07	0.0049	12,701 lx
0.50	0.14	0.0196	3,175 lx
1.00	0.28	0.0784	794 lx
2.00	0.56	0.3136	198 lx
3.00	0.84	0.7056	88 lx

Finish	Part Number
Brushed Aluminium	761-AL-XX9516
White 9010	761-WH-XX9516
Matte Anodised Black	761-EBA-XX9516
Rubbed Bronze *	761-RB-XX9516
Polished Brass *	761-PB-XX9516
Brushed Brass *	761-SB-XX9516

If M10 stud is restricting installation contact us for removal

For 3000K Substitute XX with 30

For 2700K Substitute XX with 27

\*All Brass and Bronze finishes are made to order and subject to MOQ & extended lead time

MEDIUM

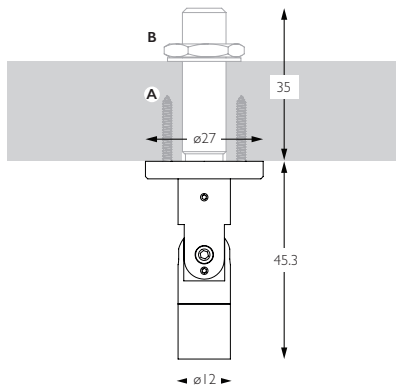

A - 2 Screw Fixing

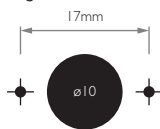

B - M10 Fixing



If M10 stud is restricting installation contact us for removal

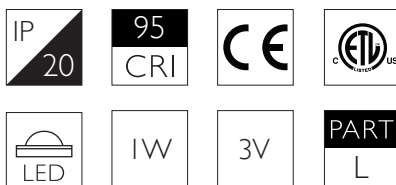

## Technical Description

Atto surface is a miniature, display orientated LED spotlight that comes as standard in white, black and brushed aluminium finishes. It has four site changeable optics for flexible distribution. The medium beam in our 1W 102lm module has a peak intensity of 359cd. The Atto has 360 degree bearing aided rotation and 180 degree constant torque tilt mechanism, both lockable. There are 2 mounting methods, from the front using screws or from the rear using the M10 threaded stud - this can be factory removed as a custom order if it restricts installation.

## Mechanical & Electrical

**Category** Interior use only IP20

**Material** Aluminium I Brass

**Lockable** Pan & Tilt

**Accessories** Snoots

**Systems** Fixed monopoint

**Weight** 16g

**Forward Voltage** 3V

**Current** 350mA

## Finishes

**Finishes** Brushed Aluminium I Black I White I Brass I Custom\*

\* Please enquire as to the availability of non-standard Finishes

## Optical

**System Power** 1W

**Module Output** 102lm

**Absolute Output** 92lm

**Gear Type** Dimmable available

**Colour Temperature** 3000K\*

**CRI** 95 TYP

**TM-30** RF: 93 RG: 99

**Beam Angle** 23°

\*\* Photometry shown is correct for 3000K module. Please enquire for 2700K module output.

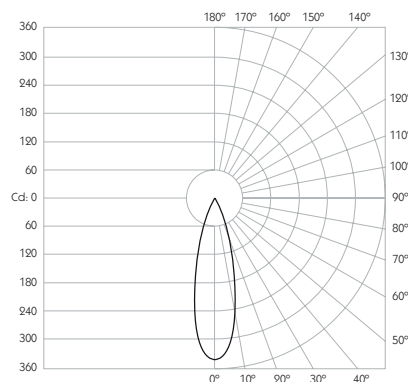

Beam Diameter (m)	Beam Angle (m)	Illuminance (lx)
0.25m	0.10m	5,745 lx
0.50m	0.20m	1,436 lx
1.00m	0.41m	359 lx
2.00m	0.81m	90 lx
3.00m	1.22m	40 lx

Brushed Aluminium	White 9010	Matte Anodised Black	Rubbed Bronze *	Polished Brass *	Brushed Brass *
761-AL-XX9523	761-WH-XX9523	761-EBA-XX9523	761-RB-XX9523	761-PB-XX9523	761-SB-XX9523

If M10 stud is restricting installation contact us for removal

For 3000K Substitute XX with 30

For 2700K Substitute XX with 27

\*All Brass and Bronze finishes are made to order and subject to MOQ & extended lead time

## FLOOD

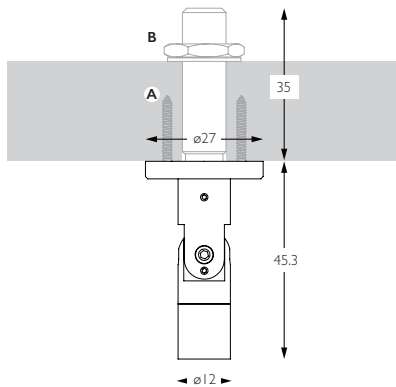

A - 2 Screw Fixing

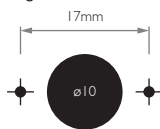

B - M10 Fixing



If M10 stud is restricting installation contact us for removal

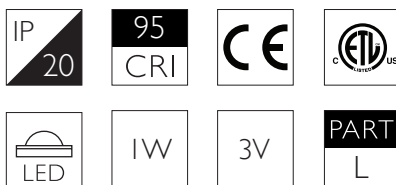

### Technical Description

Atto surface is a miniature, display orientated LED spotlight that comes as standard in white, black and brushed aluminium finishes. It has four site changeable optics for flexible distribution. The flood beam in our 1W 102lm module has a peak intensity of 109cd. The Atto has 360 degree bearing aided rotation and 180 degree constant torque tilt mechanism, both lockable. There are 2 mounting methods, from the front using screws or from the rear using the M10 threaded stud - this can be factory removed as a custom order if it restricts installation.

### Mechanical & Electrical

**Category** Interior use only IP20  
**Material** Aluminium I Brass  
**Lockable** Pan & Tilt  
**Accessories** Snoots

**Systems** Fixed monopoint  
**Weight** 16g  
**Forward Voltage** 3V  
**Current** 350mA

### Finishes

**Finishes** Brushed Aluminium I Black I White I Brass I Custom\*

\* Please enquire as to the availability of non-standard Finishes

### Optical

**System Power** 1W  
**Module Output** 102lm  
**Absolute Output** 93lm  
**Gear Type** Dimmable available

**Colour Temperature** 3000K\*  
**CRI** 95 TYP  
**TM-30** RF: 93 RG: 99  
**Beam Angle** 45°

\*\* Photometry shown is correct for 3000K module. Please enquire for 2700K module output.

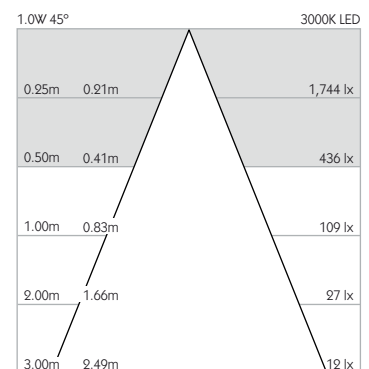
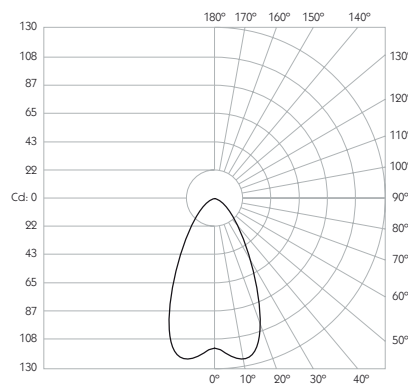

Brushed Aluminium	White 9010	Matte Anodised Black	Rubbed Bronze *	Polished Brass *	Brushed Brass *
761-AL-XX9545	761-WH-XX9545	761-EBA-XX9545	761-RB-XX9545	761-PB-XX9545	761-SB-XX9545

If M10 stud is restricting installation contact us for removal

For 3000K Substitute XX with 30

For 2700K Substitute XX with 27

\*All Brass and Bronze finishes are made to order and subject to MOQ & extended lead time

## WIDE FLOOD

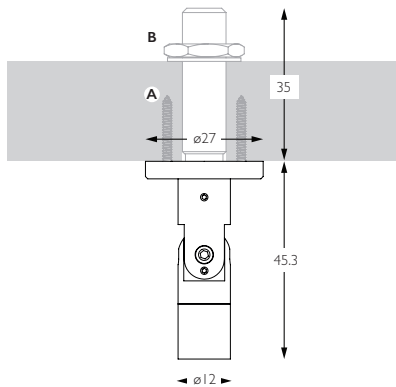

A - 2 Screw Fixing

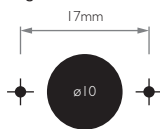

B - M10 Fixing



If M10 stud is restricting installation contact us for removal

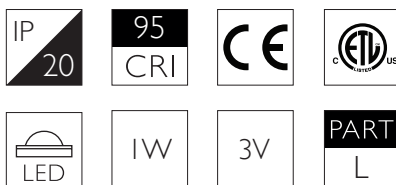

### Technical Description

Atto surface is a miniature, display orientated LED spotlight that comes as standard in white, black and brushed aluminium finishes. It has four site changeable optics for flexible distribution. The wide flood beam in our 1W 102lm module has a peak intensity of 26cd. The Atto has 360 degree bearing aided rotation and 180 degree constant torque tilt mechanism, both lockable. There are 2 mounting methods, from the front using screws or from the rear using the M10 threaded stud - this can be factory removed as a custom order if it restricts installation.

### Mechanical & Electrical

**Category** Interior use only IP20  
**Material** Aluminium I Brass  
**Lockable** Pan & Tilt  
**Accessories** Snoots

**Systems** Fixed monopoint  
**Weight** 16g  
**Forward Voltage** 3V  
**Current** 350mA

### Finishes

**Finishes** Brushed Aluminium I Black I White I Brass I Custom\*

\* Please enquire as to the availability of non-standard Finishes

### Optical

**System Power** 1W  
**Module Output** 102lm  
**Absolute Output** 69lm  
**Gear Type** Dimmable available

**Colour Temperature** 3000K\*  
**CRI** 95 TYP  
**TM-30** RF: 93 RG: 99  
**Beam Angle** 90°

\*\* Photometry shown is correct for 3000K module. Please enquire for 2700K module output.

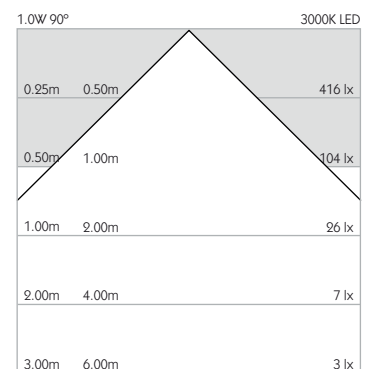
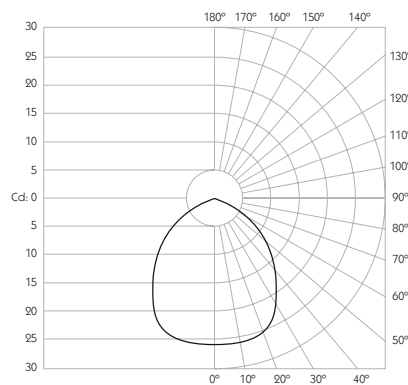

Brushed Aluminium	White 9010	Matte Anodised Black	Rubbed Bronze *	Polished Brass *	Brushed Brass *
761-AL-XX9590	761-WH-XX9590	761-EBA-XX9590	761-RB-XX9590	761-PB-XX9590	761-SB-XX9590

If M10 stud is restricting installation contact us for removal

For 3000K Substitute XX with 30

For 2700K Substitute XX with 27

\*All Brass and Bronze finishes are made to order and subject to MOQ & extended lead time